

Glass Glass

4mm Frame

Powered by DT Solar

hortisolar

HTS265M-50G

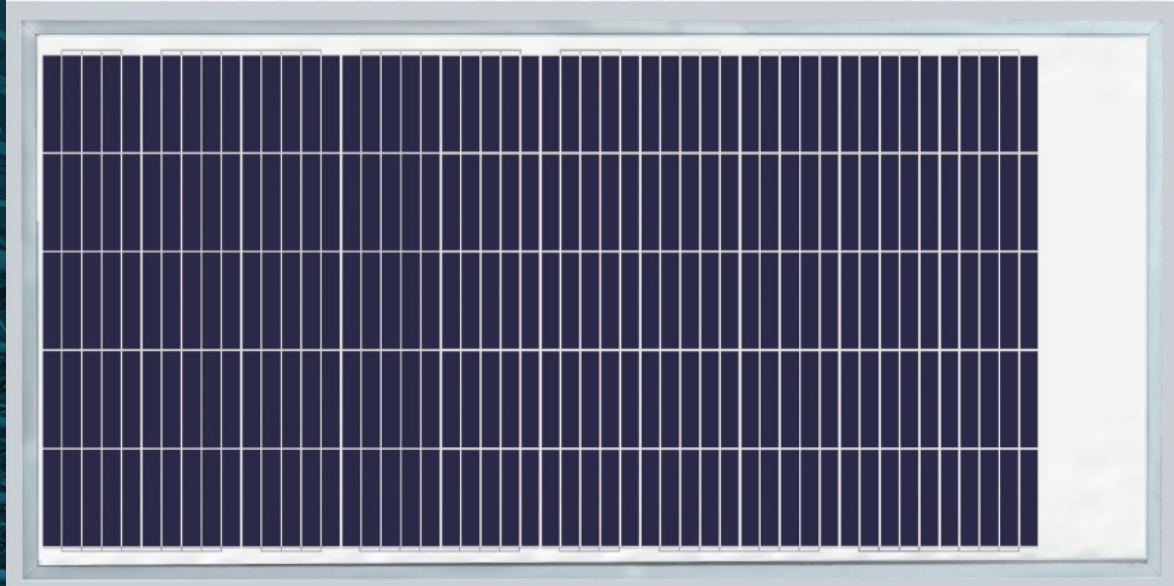

Technology

High module conversion efficiency through superior manufacturing technology



Voltage resistance

Module can withstand the 1500V system voltage



PID Free

Excellent PID resistance according to IEC TS 62804-1



Performance

High performance under low light conditions (cloudy days, mornings and evenings)



Quality

Manufactured according to International Quality and Environmental Management



Value

Our vertically integrated business model allows for competitive pricing and great value



Power output

- Our IP68 rated junction box improves module performance and stability
- High-performance connectors provide low resistance interconnection to ensure the full utilization of module output power
- Smart greenhouse cabling dc



Visible Quality

- Durable, high quality
- Rigid construction: 5400Pa & 2400Pa rated assembly
- Dirt protection



Superior Manufacturing Quality Assurance

- All modules are manufactured using TQC & SPC quality control systems
- Advanced cell sorting to avoid electric mismatch
- 100% EL Test-before lamination & prior to shipment
- Comprehensive Safety and Reliability tests are performed

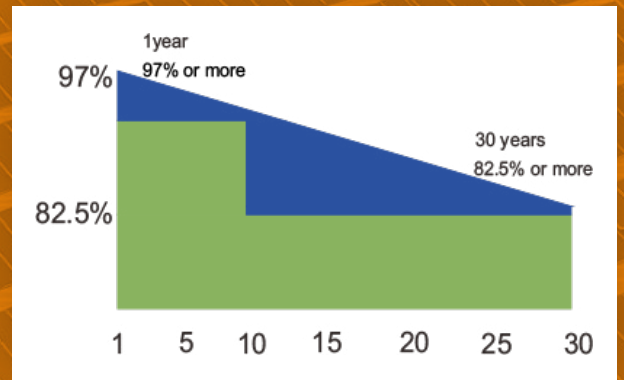

Warranty

- 15 Years Manufacturers Warranty
- Linear Power Output Warranty
- No less than 82,5% at year 30th



Electrical Specifications

STC

NOCT

Module Type	HTS265M-50GG-4	
Output tolerance	0/+3%	
Bifaciality Factor	70%±5%	
Maximum Rating Power (PM)	265W	197W
Module Efficiency	12.57%	12.57%
Open Circuit Voltage (Voc)	33.10V	30.60V
Maximum Power Voltage (VMP)	27.70V	26.04V
Short Circuit Current (ISC)	10.06A	8.42A
Maximum Power Current (IMP)	9.57A	7.57A

Bifacial Gain

10%	PM	308W
20%	PM	336W
30%	PM	364W

Mechanical Gain

Cell Type	158.75x158.75 mm
Cell Arrangement	50 (5x10)
Module structure	Glass / POE / Glass
Glass thickness	2.5mm / 2.6mm (front/back)
Application Class	Class A at IEC 61730
Junction Box Rating	IP 68
Cables (positive/Negative)	550mm / 550mm / 4mm ²
Connector Type	MC4 / MC4 Compatible
Fire Rating Class	Class A

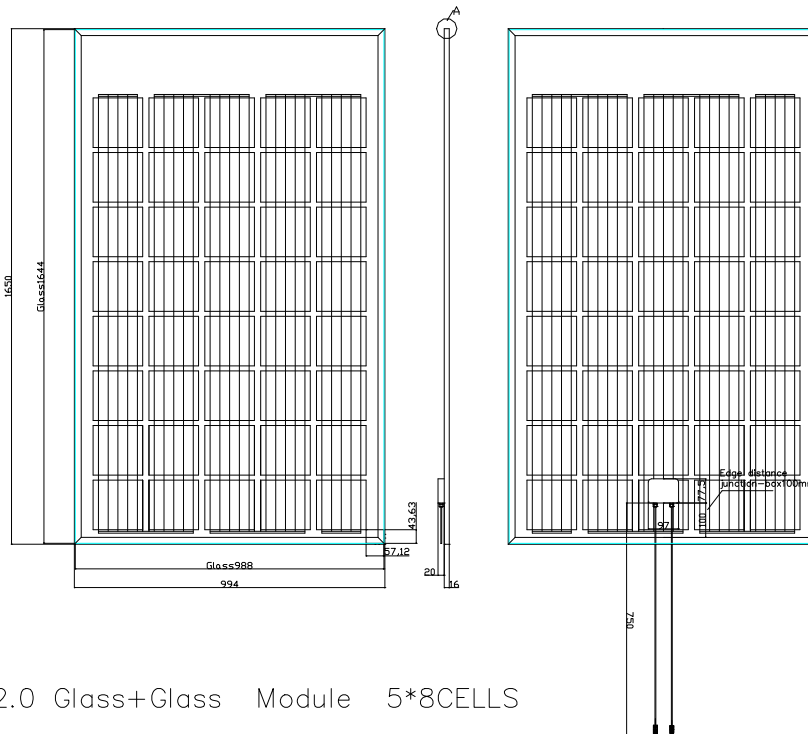
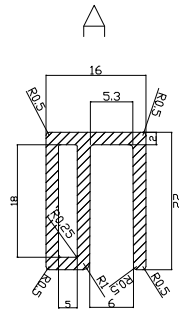

2.0 Glass+Glass Module 5*8CELLS

Pm?210W

Isc: 9.98A, Voc: 26.44V?Im: 9.51A, Vm: 22.08V

System Voltage: 1500V

Series Fuse Rating: 20A

JB: IP67

Diode QTY: 3

Maximum Ratings

Operating Temperature	-40°C WR +85°C
Maximum Load capacity	Snow 5400Pa / Wind 2400Pa
Maximum system Voltage	1000V / 1500V DC(IEC)
Maximum series fuse rating	20A
Number of diodes	5

Packaging

Module Dimensions	2120x994x4mm
Weight	17 Kg
Pallet Dimensions	22455x1140x1170mm
Container	40' HQ
Pieces per pallet	33
Pallets per container	22
Pieces per container	561
Gross Weight per Pallet	622 Kg
Gross Weight per Container	12342 Kg

Temperature Characteristics

Nominal Module Operating Temperature (NMOT)	42°C ± 3°C
Temperature Coefficient of Isc	+0.038%/°C
Temperature Coefficient of Voc	-0.270%/°C
Temperature Coefficient of Pmax	-0.365%/°C

* STC irradiance of 1000W/m² spectrum AM 1.5 and cell temperature of 25 °C
 NOCT irradiance of 800W/m² Ambient temperature 20 °C AM=1.5 Wind speed 1/m/s

Current-Voltage&Power-Voltage Curve(290W)

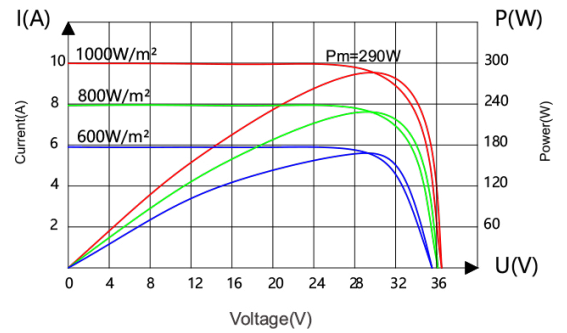

Temperature Dependence of Isc, Voc, Pmax(°C)

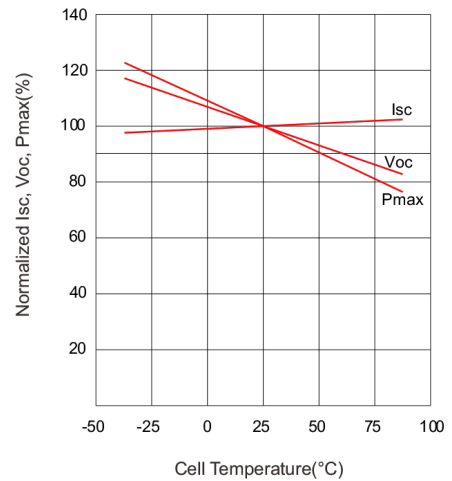



hortisolar

📍 Honderdland 308, 2676 LV Maasdijk

✉ info@hortisolar.nl

🌐 www.hortisolar.nl